



INSTRUCTION BULLETIN

No. 340206
Machine: ATLV 4300
Published: 10-98/00
System: OPTIONS

NOTE: DO NOT DISCARD the Parts List from the Instruction Bulletin. Place the Parts List in the appropriate place in your machine manual for future reference. Retaining the Parts List will make it easier to reorder individual parts and will save you the cost of ordering an entire kit.

NOTE: Numbers in parenthesis () are reference numbers for parts listed in Bill of Materials.

Installation instructions for kit number 368107

SYNOPSIS / PROBLEM:

This kit contains the parts needed to install a filter bag update kit on the model ATLV 4300
Please follow step-by-step instructions.

SPECIAL TOOLS / CONSIDERATIONS: Hand drill, .094 inch drill bit

(Estimated time to complete: 1 hour)

PREPARATION:

(Refer to FIG. 1 and 3)

FOR SAFETY: Before leaving or servicing machine, stop on level surface and set parking brake. Then turn off machine and remove key.

1. Go to the rear of the machine. Remove the existing quick release clamp. This clamp is not used with the new black filter bag (4), however, it is used with the dust bag kit (#368106)
(Refer to FIG. 3)
2. Remove and discard the filter bag. (Refer to FIG. 3)
3. Remove and discard the existing top channel, side channels, and foam seal. (Refer to FIG. 3)
4. Remove and discard the existing fan outlet guard and round tubes. (Refer to FIG. 1)

PREPARATION:

(Refer to FIG. 2 and 3)

FOR SAFETY: Before leaving or servicing machine, stop on level surface and set parking brake. Then turn off machine and remove key.

1. Use the new vacuum exhaust plate (1) as a template to mark and drill the six mount holes on the outlet flange of the vacuum fan housing. Drill the six holes .094 inch. Install the plate with the flange up, toward the machine. (Refer to FIG. 2)
2. Install the new vacuum exhaust plate (1) onto the outlet flange of the vacuum fan housing using the six screws (2). Hand tighten. (Refer to FIG. 2)
3. Install the rigid molding (3) onto the edge of the new vacuum exhaust plate (1).
(Refer to FIG. 2)
4. Install the new filter bag (4) onto the new vacuum exhaust plate (1). (Refer to FIG. 3)
5. Reinstall the existing filter bag quick release clamp. (Refer to FIG. 3)

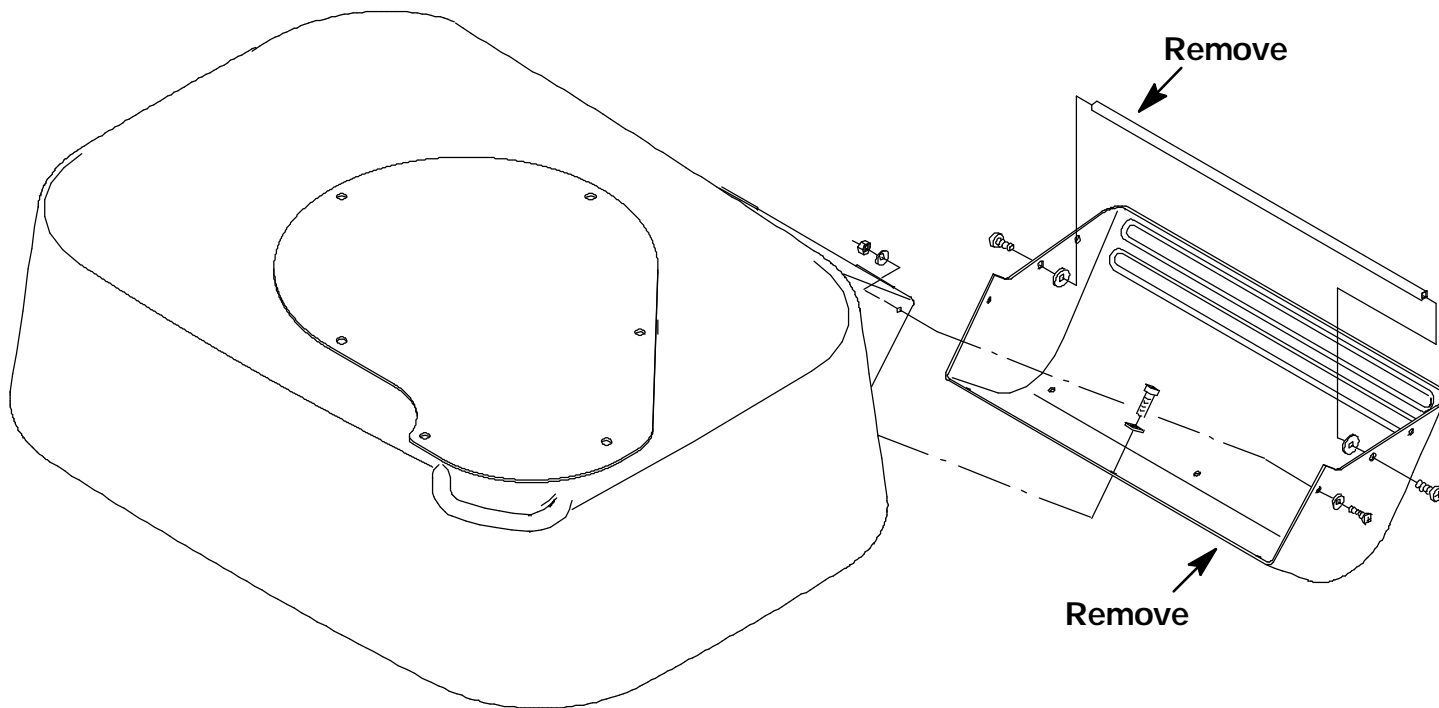

FIG. 1 - Vacuum Fan Housing

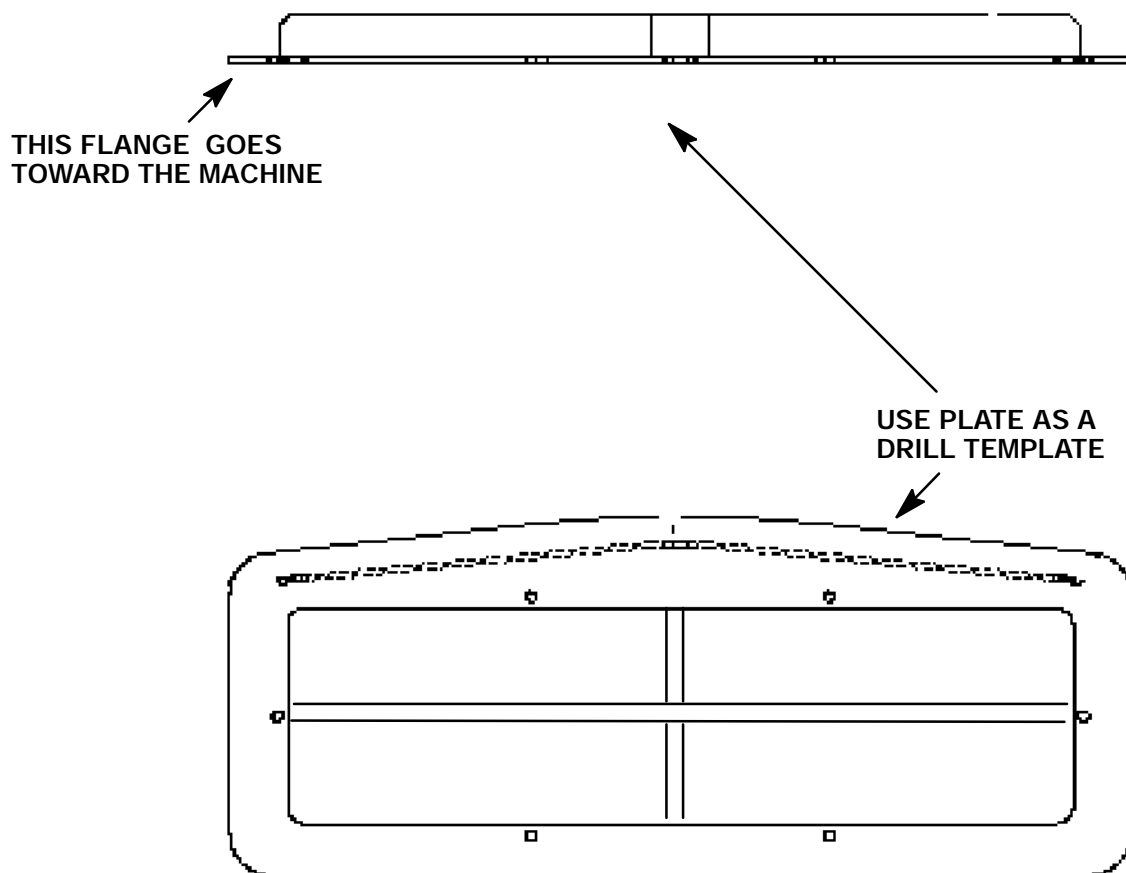

FIG. 2 - Vacuum Exhaust Plate (368035)

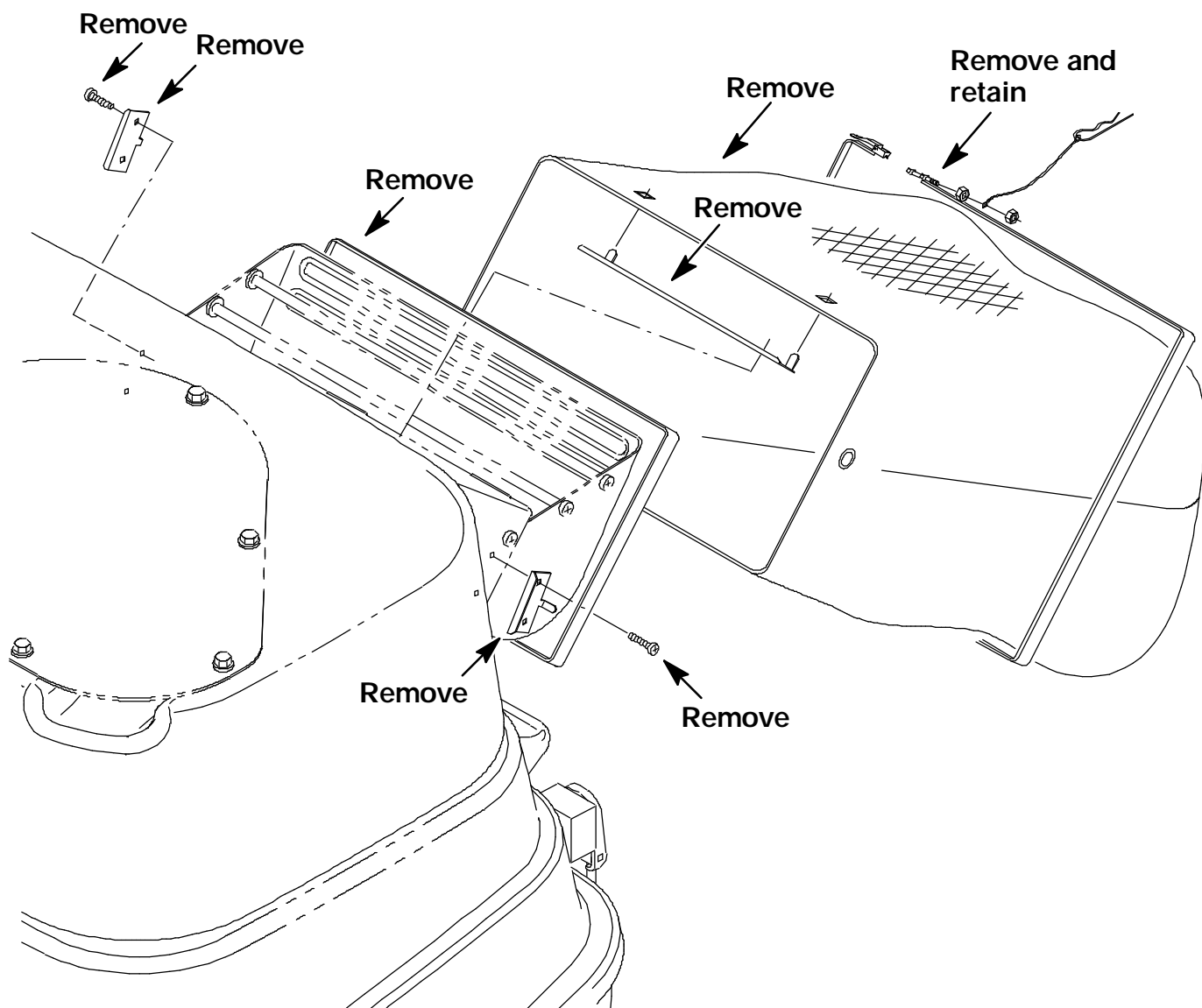

FIG. 3 - Filter Bag Assembly

BILL OF MATERIALS FOR FILTER BAG UPDATE KIT 368107

Ref.	TENNANT Part No.	Description	Qty.
1	368035	Vacuum exhaust plate	1
2	360973	Pan screw, #12x .50	6
3	368038	Rigid molding, 54.75 inch L.	1
4	368108	Filter bag	1

TENNANT COMPANY
P. O. Box 1452
Minneapolis, MN 55440-1452